

Panel Cutout

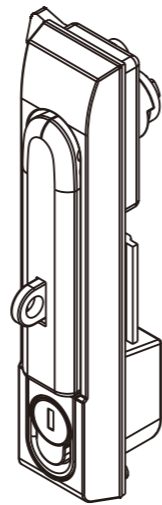

Zinc die body, black smooth powder coated

Version A (Cam control)		
	Padlockable	Without padlock
Black Smooth Powder Coated	2234-2002-20-P	2264-2002-20

Accessories ref. to page #
1. CAM ref. to page 9A-001

Remark
1. Padlockable on request

Swinghandle

2234

Rod Control Swinghandle

2234

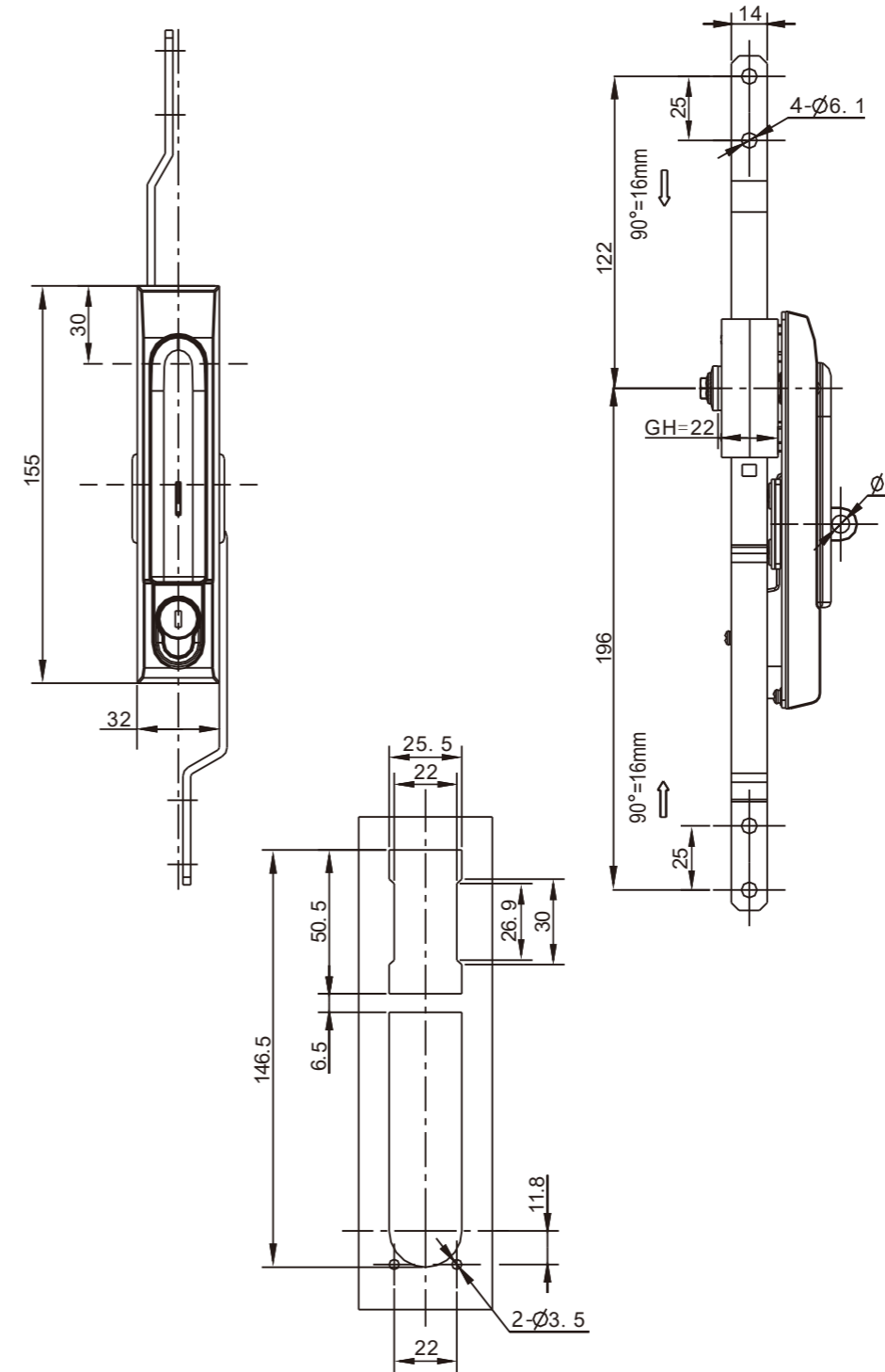

Zinc die body, black smooth powder coated

	Version B (2Prod control)	Version C (3Prod control)
	Black Smooth Powder Coated	Black Smooth Powder Coated
Padlockable	2234-4002-20-P	2234-6002-20-P
Without padlock	2234-4002-20	2234-6002-20



Accessories ref. to page #
1. CAM ref. to page 9A-001

Remark
1. Padlockable on request